



## SACE20/25

### Economical Mobile Scale Truck

#### INTRODUCTION

The SACE20/25 is an economical mobile scale truck with integrated load indication system. The robust system is ideal for the cost-conscious users who have the demand of the mobile weighing with not so high accuracy. The compact mechanical weighing system is integrated on the top of the A-frame and well protected with metal housing. It shows a weight indication in steps of 20kg with maximum load up to 2500kg. No electric parts or cables is installed, thus weight indication system is maintenance-free. For the best accuracy the goods has to be lifted to the reference height for weight-reading. The SACE20/25 is with the lever indicator when the height is reached, easy and comfortable.

#### ADVANTAGES

- Compact and smart design at economical cost.
- Maximum loading Capacity 2,000kg /2,500kg
- Graduation 200kg - 2500kg: 20kg
- Weighing accuracy 200-2500kg range -> +/-50kg
- Easy solution with lever indicator for optimized weighing.
- Simple and fast weight control for warehouse and lorries.

## PARAMETERS

| Technical data sheet 1KG=2.2LB 1INCH=25.4MM |   |
|---|---|
| Model                                       | SACE20/25   |
| Capacity                                    | 2,000kg /2,500kg  |
| Graduation                                  | 200 – 2500kg: 20kg  |
| Weighing accuracy                           | 200-2500kg range -> +/-50kg                                 |
| Height, lowered, h13                        | 85mm  |
| Lift height, h3                             | 115mm   |
| Forks dimensions, s/e/L                     | 50/160/1150mm <sup>1)</sup>                                 |
| Distance between forks, b5                  | 540mm   |
| Overall size, L1 * h14                      | 1540*1220mm   |
| Environment                                 | General purpose, dry, little rain                           |
| Operating temperature                       | to 40oC (32oF to 104oF) with<br>10 to 95% relative humidity |
| Noise level                                 | less than 70dB.   |

<sup>1)</sup> L = 800/ 900/ 1000/1100/ 1220 mm optional

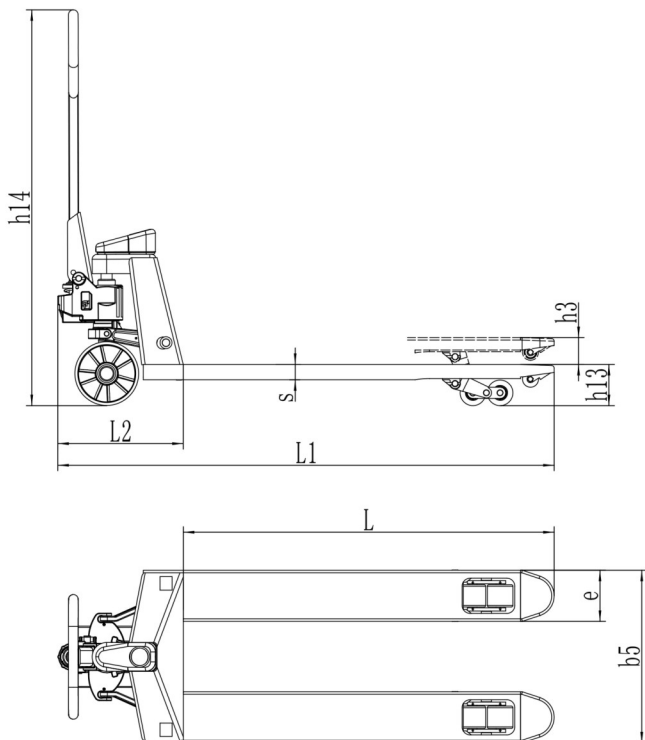

## KEY FEATURES

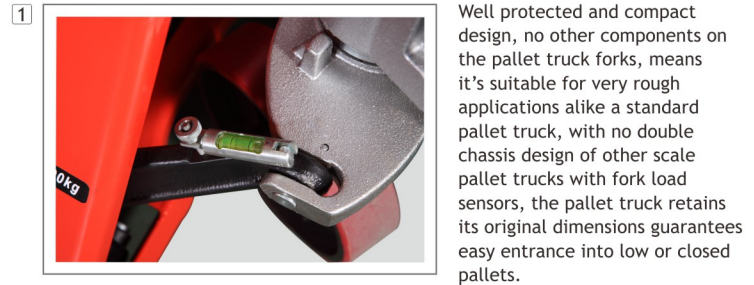

- 2 Level gauge with the air blister to confirm the weighting height, and the adjustable design makes it easy and comfortable to operate.
- 3 Ip65 Ingress Protection allows it for general purpose, dry, little rain environments, operating temperature: -10oC to 40oC (14oF to 104oF) with 10 to 95% relative humidity.

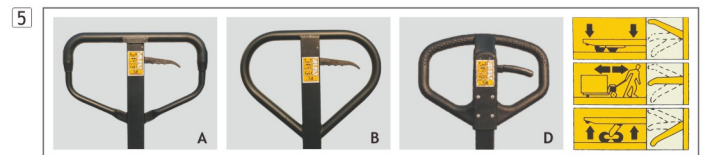

Option of ergonomically designed handles, with option of comfortable rubber grip or robust whole steel handle, or one-piece plastic cover allows the optimized safety as well as comfortable.

Three position operational handle lever for lifting, transporting and lowering purposes.

Lower Position---to lower load, pull up on the finger tip control.

Neutral Position---to place finger tip control in this position during pulling the truck or load.

Lift Position---to raise load, push down on finger tip control, pump handle to raise the load.



Option of different coating material for both steering wheel and fork rollers.

Polyurethane---Ideal for delicate floors with hard wearing and non-marking property, quiet and durable.

Nylon---low drag efforts, high resistance to chemicals, non-marking, preferred in food, fishing and chemical industries with smooth level floors.

Rubber---Best choice for quiet and durable demands, ideal for smooth and rough floors.